



**ADDENDUM No. 1**  
**FGC Buildings 08 and 09 Demolition**  
**Florida Gateway College**  
**NFPS PROJECT NO. L171127FGC**  
February 20, 2019

**SPECIFICATION REVISIONS**

SECTION 01500 - TEMPORARY FACILITIES AND CONTROLS

**Delete the following:**

1.1 SECURITY AND PROTECTION FACILITIES INSTALLATION

- G. Fencing: Install fencing of type and location as indicated. Install fence in accordance with the specifications of the Florida Department of Transportation.

**Replace with:**

**2017 FLORIDA BUILDING CODE, SIXTH EDITION**

**453.6 Administration of public education projects.**

**453.6.1 Occupancy during construction.**

School board and Florida college board facilities, or portions of facilities, shall not be occupied during construction unless exits, fire detection and early warning systems, fire protection, and safety barriers are continuously maintained and clearly marked at all times. Construction on an occupied school board site shall be separated from students and staff by secure barriers. Prior to issuance of the notice to proceed, a safety plan shall be provided by the contractor which clearly delineates areas for construction, safety barriers, exits, construction traffic during the various phases of the project and when conditions change. Where heavy machinery, as is used for earth moving or scraping, is required to work on a school board's occupied site, the work shall be separated from occupants by secure double barriers with a distance of 10 feet (3048 mm) in between. New construction, remodeling or renovations in existing facilities shall not reduce the means of egress below the requirements for new buildings; safe means of egress from a student-occupied space may be accomplished as authorized by NFPA 101, Florida edition as adopted by the Florida Fire Prevention Code. New construction (additions) shall not block or reduce safe means of egress.



## **DRAWING REVISIONS**

### **C 2.0 DEMOLITION PLAN**

Drawing revised as indicated:

1. Existing sidewalk south of building to remain and not be demolished as previously shown.
2. Existing 4-inch Chilled Water line to be plugged and isolation gate valve added as shown on the revised drawing
3. Added location and quantity of construction fence around perimeter of project.

### **C 5.0 UTILITY PLAN**

Drawing added for Contractor's reference to show proposed future utility connections to the new STEM Building

**NOTE:**

1. EXISTING BOILER TO BE REMOVED BY FLORIDA GATEWAY COLLEGE.
2. LOCATION OF SITE UTILITIES SHALL BE VERIFIED BY GENERAL CONTRACTOR & THE PROPER UTILITY COMPANY PROVIDING SERVICE
3. THE CONTRACTOR SHALL GIVE NOTICE TO THE OWNERS OF TO THE UTILITY FACILITIES SHOWN ON THE PLAN. SAID NOTICES SHALL BE GIVEN AT LEAST TWO WORKING DAYS PRIOR TO THE START OF CONSTRUCTION.
4. THE FLOW IN ALL THE SEWERS, DRAINS, AND WATERCOURSES ENCOUNTERED SHALL BE MAINTAINED BY THE CONTRACTOR AT HIS OWN EXPENSE, & WHENEVER SUCH WATERCOURSES & DRAINS ARE DISTURBED OR DESTROYED DURING THE PROSECUTION OF THE WORK, THEY SHALL BE RESTORED BY THE CONTRACTOR AT HIS OWN COST AND EXPENSE.
5. ALL STORM SEWERS TO REMAIN THAT ARE DAMAGED, DISTURBED OR REMOVED AS A RESULT OF THE CONTRACTOR'S OPERATIONS SHALL BE REPLACED WITH THE SAME QUALITY PIPE OR BETTER, MAINTAINING THE SAME GRADIENT AS EXISTING.
6. THE CONTRACTOR SHALL NOTIFY ALL AFFECTED UTILITY COMPANIES PRIOR TO THE DEMOLITION OF ANY EXISTING STRUCTURES. ALL EXISTING UTILITIES SHALL BE CAPPED OFF OR REMOVED SO AS NOT TO INTERFERE WITH THE CONSTRUCTION PROJECT. APPROPRIATELY FLAG CAPPED LOCATION OF ALL UTILITIES SEVERED DURING DEMOLITION. ALL DEBRIS SHALL BE HAULED AWAY FROM THE SITE AND DISPOSED OF AT AN APPROVED LANDFILL UNLESS SPECIFIED OTHERWISE.
7. THE CONTRACTOR SHALL NOTIFY THE ENGINEER AND THE OWNER PRIOR THE ANY REMOVAL OF ANY SUBSURFACE STRUCTURES NOT DESIGNATED ON THE CONSTRUCTION PLANS.
8. THE CONTRACTOR SHALL REMOVE AND DISPOSE OF ALL EXISTING STRUCTURES, VEGETATION, FENCES, CONCRETE, PAVEMENT, IRRIGATION, ELECTRICAL CONDUIT, ETC. WITHIN THE LIMITS OF DISRUPTION UNLESS NOTED TO REMAIN OR OTHER PROVISIONS ARE NOTED.
9. ALL UTILITIES BELOW EXISTING BUILDING/STRUCTURES SHALL BE REMOVED.
10. REMOVED ITEMS SHALL BE HAULED AWAY AND DISPOSED OF AT AN APPROVED AND LICENSED OFF-SITE LOCATION.
11. SAW CUT THE EDGES OF EXISTING PAVEMENT AND CURB AT LOCATIONS WHERE EXISTING IS TO MEET PROPOSED TO PROVIDE A SMOOTH EDGE.
12. THE EXISTING PRIVATE SANITARY SEWER TO THE BUILDING BEING CALLED OUT FOR REMOVAL SHALL BE PROPERLY ABANDONED AT THE OUTLET MANHOLE. THE EXISTING BOOT, IF A BOOT CONNECTION, MUST BE REMOVED FROM THE STRUCTURE. THE TAP OPENING MUST BE SEALED WITH A CONCRETE & BRICK BULKHEAD THAT IS WATER TIGHT. THE MANHOLE BOTTOM MUST BE RE-CHANNELED AS REQUIRED TO PROPERLY ROUTE THE FLOW.

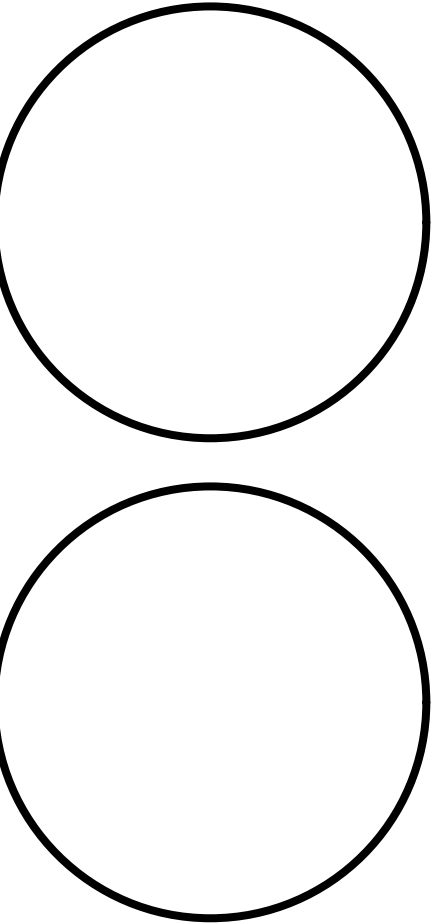
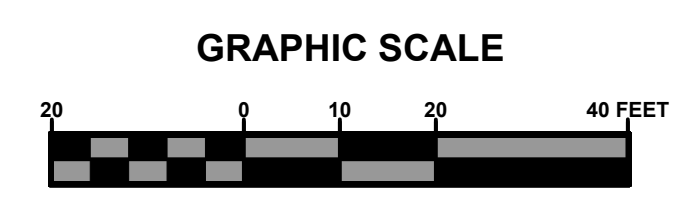
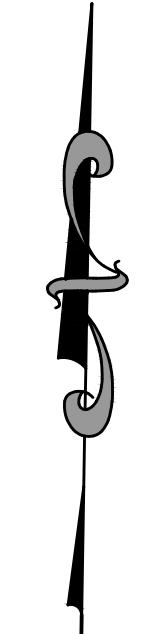
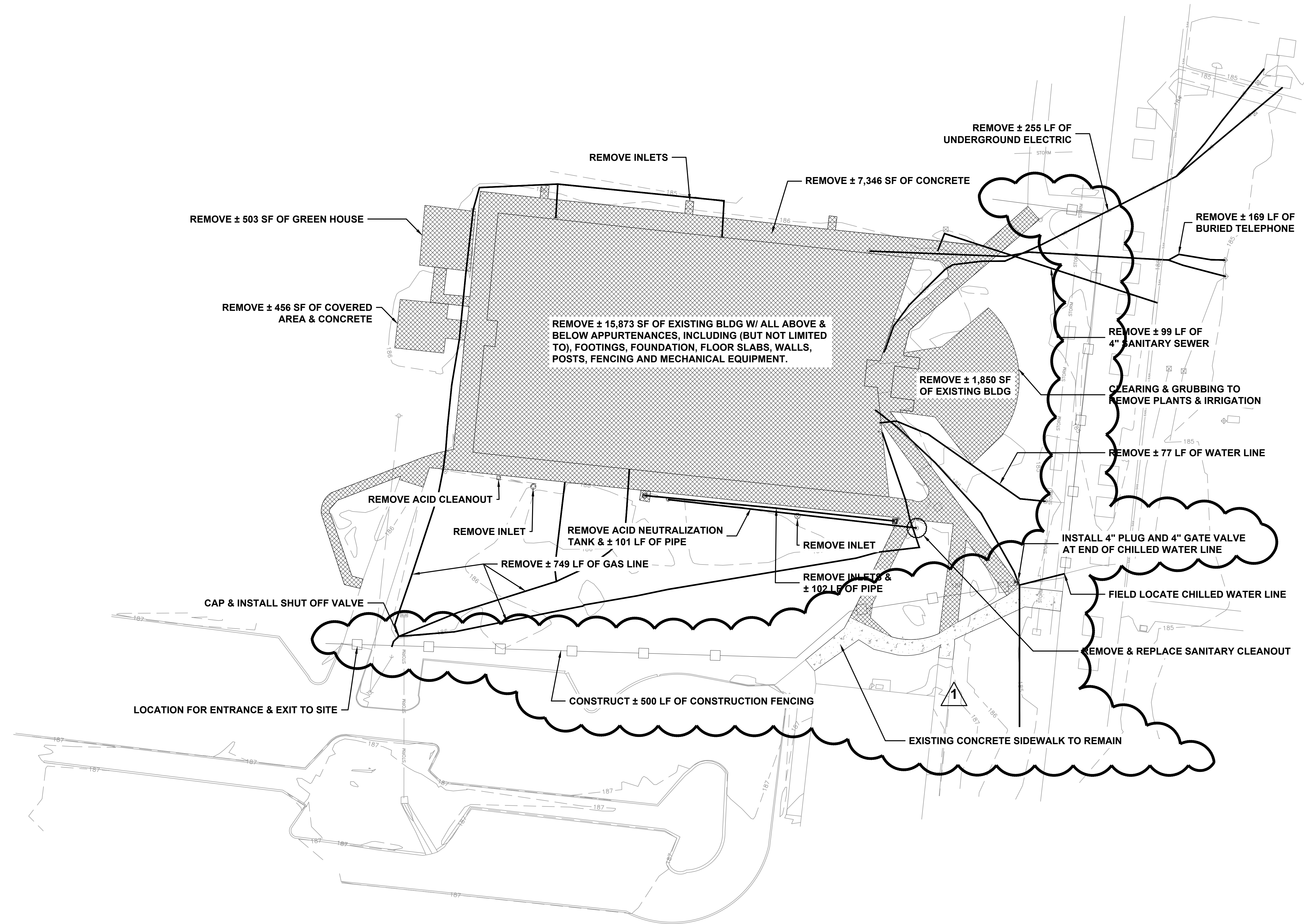

**NEW STEM FACILITY**  
149 SE COLLEGE PL.  
LAKE CITY, FL 32025

**FLORIDA GATEWAY COLLEGE**

**DESIGN DEVELOPMENT**

Revisions  
 EXISTING CONCRETE SIDEWALK TO REMAIN  
 FIELD LOCATE CHILLED WATER LINE  
 CONSTRUCT CONSTRUCTION FENCE

**DEMOLITION PLAN**

**North Florida Professional Services, Inc.**  
 P.O. BOX 3823 Lake City, FL 32025 Ph. 386-752-4675 Fax. 386-752-4674  
 P.O. BOX 180998 Tallahassee, FL 32318 Ph. 877-335-1525 Eng. Lic. 29011

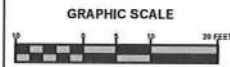

**NEW STEM FACILITY**  
149 SE COLLEGE PL.  
LAKE CITY, FL 32025

**FLORIDA GATEWAY COLLEGE**

**DESIGN DEVELOPEMEI**

UTILITY PLAN



North Florida Professional Services, Inc.  
 P.O. BOX 3823  
 Lake City, FL 32025  
 Ph. 386-752-4675  
 Fax. 386-752-4674

P.O. BOX 189998  
 Tallahassee, FL 32318  
 Ph. 877-335-1525  
 Eng. Lic. 29011